

Snap! Card 03

3. Key Mouse Moves

1. Select the file symbol and select **Costumes** & Replace the turtle/robot with any **mouse** then select the **Scripts** tab for coding



2. Select under yellow **Control** four **When space key pressed** and choose **up arrow**, **down arrow**, **left arrow**, and **right arrow**

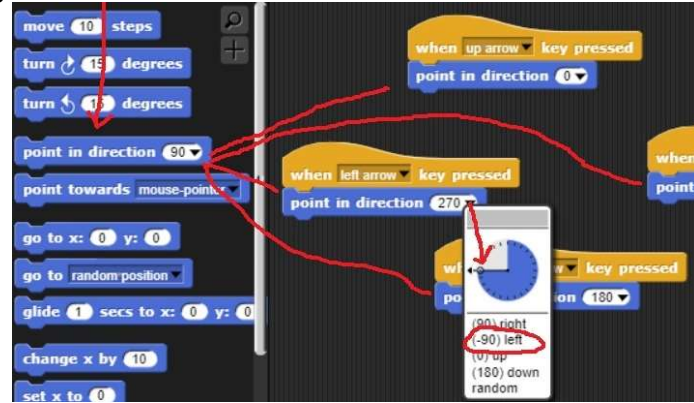
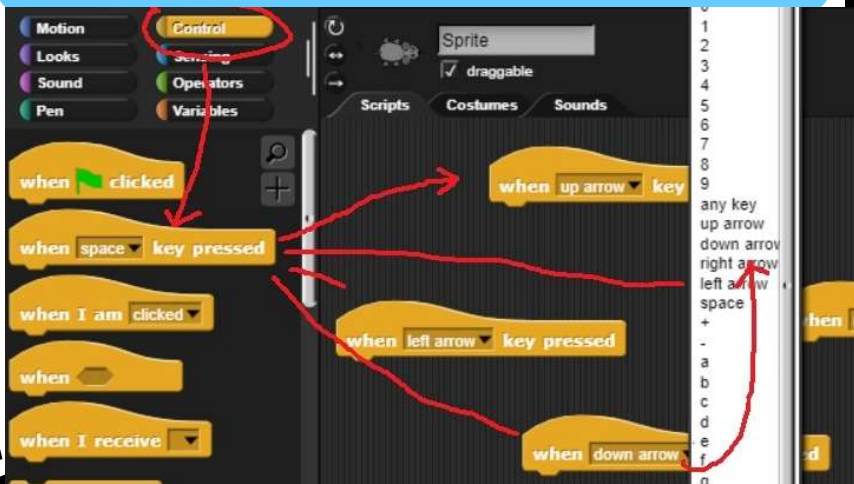

3. Select under blue **Motion** blocks **Point in direction** **go** and change the values either by the angle arrows or direction bricks to point up, down, left, and right. Pull over blue **Motion** **move 10 steps** values.

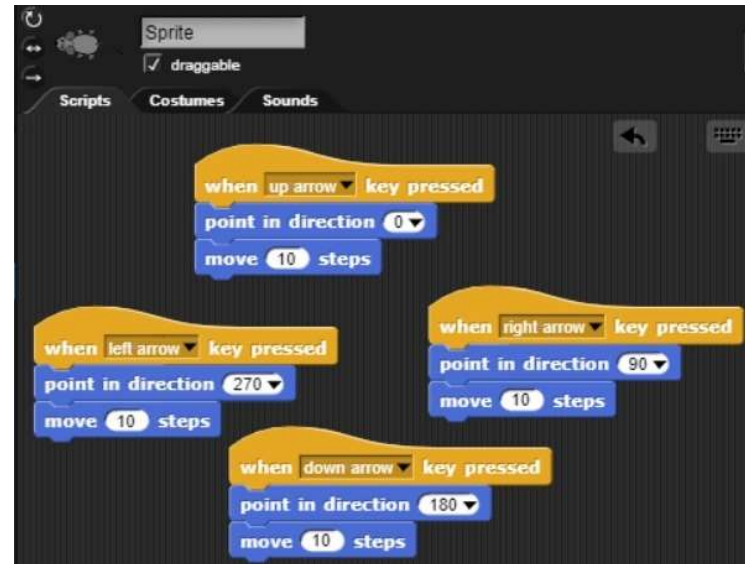

<https://snap.berkeley.edu/> and choose **Run Snap!**

Make A Card



1. Fold the card in half.



2. Put glue on the back.



3. Cut along the dashed line.